

# USER MANUAL



Thank you for choosing Better Bathrooms.  
Please read this manual before installing your product  
and keep for future reference.

**better**   
**bathrooms**

## Product

ARBCSBW Black Chrome Slotted Basin Waste - Arissa

BBZSLOTW Brushed Bronze Slotted Basin Waste - Arissa

ARBCUSBW Black Chrome Unslotted Basin Waste - Arissa

BBZUNSLOTW Brushed Bronze Unslotted Basin Waste - Arissa

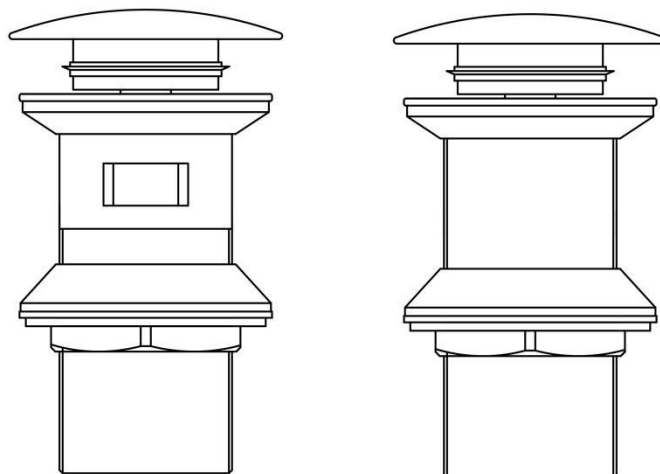

- **Single-person assembly**
- **We always recommend using professional tradespeople to install your product**

V3\_6/12/2025

**Congratulations on your purchase**

*And welcome to our growing gang of savvy shoppers*

We're on a mission to bring you extraordinary bathroom products, for less. From modern to traditional style ceramics, plus the gorgeous fixtures, fittings and furniture to match. So, you can fall in love with your space every single day.

As one of the UK's largest independent bathroom stores, we've received countless awards; including the National Business Awards UK, the Digital Entrepreneur Awards and being placed on The Sunday Times Fast Track 100.

We hope your new product goes above and beyond your expectations. However, should any problems occur, please:

- log in to your account and contact our customer services team via your self-serve portal – [betterbathrooms.com/CustomerAccount/Login](https://betterbathrooms.com/CustomerAccount/Login)
- contact us via [betterbathrooms.com/content/contact-us](https://betterbathrooms.com/content/contact-us)

## **Important information**

- Please read these instructions thoroughly and retain for future reference
- Installation must be carried out in compliance with The Water Fittings Regulations and Scottish Water Byelaws.

Parts / Diagrams

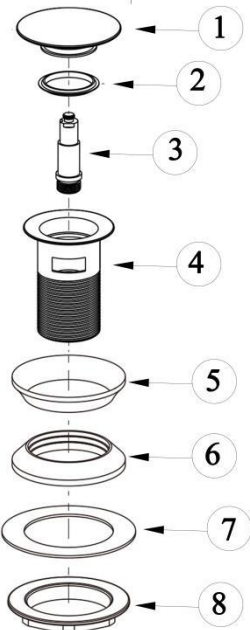
	No	Part Description
	1	Clicker dome
	2	O-ring
	3	Piston kit
	4	Drain body
	5	Rubber Washer
	6	Rubber Washer
	7	Plastic gasket
	8	Lock nut

Dimensions

ARBCUSBW /BBZUNSLOTW

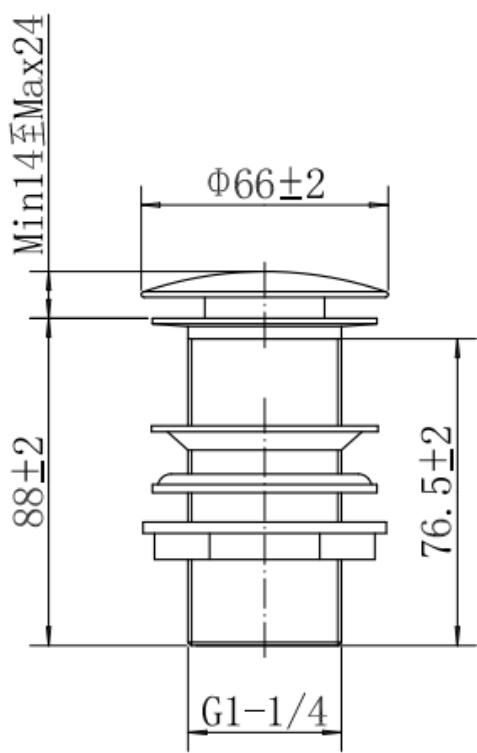

ARBCSBW/BBZSLOTW

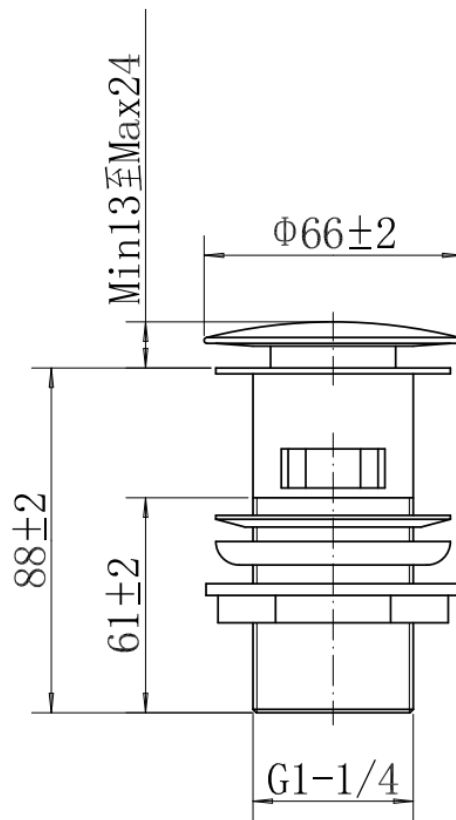

## Tools required

- Seal tape
- Spanner

## Installation

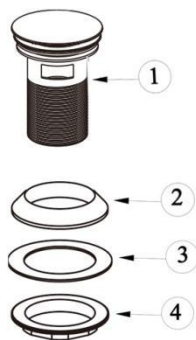

### Slotted/Unslotted Basin Waste

**Note: Silicone sealant can be used.**

- Unscrew the locknut(4) , and remove the plastic gasket(3) and rubber washer(2).
- Insert the drain body(1) from above the basin. For the slotted basin waste, make sure the slot lines up with the overflow on the basin.
- Install the rubber washer(2), plastic gasket(3) and tighten with locknut(4)).
- To fill the basin, the Clicker mechanism requires pressing down the clicker dome, and pressing it again to release the water.
- Check all the joints for leaks.

## Troubleshooting

Issues	Check
Drain body loose	<ul style="list-style-type: none"> <li>• Is lock nut(8) fully tighten</li> <li>• Is the clicker dome(1) fully tighten</li> </ul>
Water leak	<ul style="list-style-type: none"> <li>• Is there damage or dirt with the o-ring(2)</li> <li>• Is there damage or dirt with the rubber washers(5 or 6)</li> </ul>

## Maintenance and Cleaning

To maintain the surface of your product, wipe with a clean damp cloth and wipe dry, do not use any abrasive cleaning agents or materials.

If any harsh chemicals come into contact with the surface of the product, rinse and wipe clean immediately.

### ***For more information***

- visit [betterbathrooms.com](http://betterbathrooms.com)
- email [customerservices@buyitdirect.co.uk](mailto:customerservices@buyitdirect.co.uk)
- call 03303903062
- write to Trident Business Park, Neptune Way, Huddersfield, HD2 1UA

**better  
bathrooms**

Part of the BuyItDirect Group